



ADVANTAGE HOMES

2017 N. HARMONY TOWN HALL RD.
JANESVILLE, WI 53546
608.756.2989 EXT 141



Located in the Huntington Place Condominiums II development, Advantage Homes brings you this modern condo with a contemporary feel and all homeowner amenities. Perks include accessible location, flexibility, and low-home maintenance.

**3629 Newcastle Drive
Janesville**

SQUARE FEET: 1,416 | BEDS: 2 | BATHS: 2

A Must-See, Charming Custom-Built Ranch

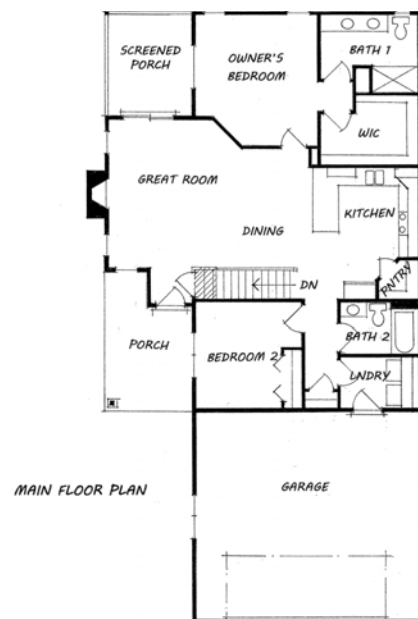

Home Features:

- 9' CEILINGS ON MAIN FLOOR AND PLASTER WALLS
- QUARTZ KITCHEN COUNTERTOPS
- MAPLE STAINED CABINETS AND DRAWERS
- GAS FIREPLACE IN GREAT ROOM
- LARGE KITCHEN PANTRY
- CULTURED MARBLE BATHROOM COUNTERTOPS
- FIRST-FLOOR LAUNDRY WITH CABINETS
- 10' X 12' FULL-SCREEN REAR PORCH
- 10' X 12' CONCRETE FRONT PATIO

www.buildadvantagehomes.com